

SHILLONG



COLLEGE

Assessed and Re-Accredited by NAAC as Grade B (2.92) (2010)

Ref. No. :

Date :

Certificate of Compliance

(Affiliated/Constituent/Autonomous Colleges and Recognized Institutions)

This is to certify that Shillong College fulfils all norms

1. Stipulated by the affiliating North Eastern Hill University and
2. Regulatory Council/Body : UGC and
3. The affiliation and recognition is valid as on date.

It is noted that NAAC's accreditation, if granted, shall stand cancelled automatically, once the institution loses its University affiliation or Recognition by the Regulatory Council, as the case may be.

In case the undertaking submitted by the institution is found to be false then the accreditation given by NAAC is liable to be withdrawn. It is also agreeable that the undertaking given to NAAC will be displayed on the college website.

(Dr. K. D. Ramsiej)

Date :

Principal/Head of the Institution

Place : Shillong

(Name and Signature with Office seal)

P.O. Laitumkhrab, Shillong – 793003
Meghalaya.

 shillcoll@yahoo.co.in
 2224903
 (0364) 2502143
website : Shillongcollege.ac.in

SHILLONG



COLLEGE

Assessed and Re-Accredited by NAAC as Grade B (2.92) (2010)

Ref. No. :

Date :

Declaration by the Head of the Institution

I certify that the data included in this Self-Study Report (SSR) are true to the best of my knowledge.

This SSR is prepared by the Institution after internal discussions, and no part thereof has been outsourced.

I am aware that the Peer team will validate the information provided in this SSR during the peer team visit.

Date:

Place

29/7/15
(Dr. K. D. Ramsiej)
Principal

ANNEXURE - I

Affiliation Certificate from the University

**NORTH-EASTERN HILL UNIVERSITY**

Permanent Campus, Mawlai Mawkynroh,

Shillong – 793022 (Meghalaya)

Dated: 11th MARCH, 2015TO WHOM IT MAY CONCERN

This is to certify that **SHILLONG COLLEGE**, Boyce Road, Shillong – 793003, Meghalaya, is affiliated to North Eastern Hill University since 1972 and recognized by the University Grants Commission with 2(f) and 12(B) status, and the following Courses/Subjects are taught in the said College as per approval:

Sl. No.	Name of the Courses and Duration	Affiliation		Period of Validity for the year(s)
		Permanent	Temporary	
1.	Three Years B.A. Honours Courses in English, Khasi, Economics, Political Science, History, Education, Philosophy	Permanent		-----
2.	Three Years B.A. Pass Courses	Permanent		-----
3.	Three Years B. Com. Honours Course	Permanent		-----
4.	Three Years B. Com. Pass Course	Permanent		-----
5.	Three Years B. Sc. Honours Courses in Botany, Chemistry, Mathematics, Physics, Zoology	Permanent		-----
6.	Three Years B. Sc. Pass Courses	Permanent		-----
7.	Three Years Bachelor of Business Administration (B.B.A.) Course		Temporary	Upto 2015-2016
8.	Three Years Bachelor of Computer Application (B.C.A.) Course		Temporary	Upto 2015-2016
9.	Three Years B.A. Honours Course in Sociology		Temporary	Upto 2015-2016
10.	Three Years B.A. Pass Course in Sociology		Temporary	Upto 2015-2016
11.	Three Years B. Sc. Pass Course in Statistics		Temporary	Upto 2015-2016
12.	Three Years B.Sc. Honours Course in Computer Science		Temporary	Upto 2015-2016
13.	Three Years B.Sc. Honours Course in Microbiology		Temporary	Upto 2015-2016

Name _____

Designation _____

Seal & Signature

ANNEXURE - II

Certificate of Recognition under sections 2f and 12B from UGC as available in UGC website



University Grants Commission

Ensuring Quality Higher Education

Select Search Option

Select Search Option



- Inside Higher Education
- Professional Councils
- Other Stakeholders
- Universities
- Colleges
- Academic Mobility
- Professors' Directory
- IET
- Statistics
- Faculty Corner
- Pay Related Matters
- Students Corner
- Fake University Alerts
- Educational Loan

Colleges

List of Colleges-> Meghalaya

- College of Teacher Education, Boyce Road SHILLONG-793003, DIST.: East Khasi Hills, Meghalaya Yr Estd.: 1964 Status: 2(f)&12(B)
- College of Teacher Education, Rongkhon, Tura, West Garo Hills, Meghalaya Yr Estd.: 1993 Status: 2(f)&12(B)
- Don Bosco College, Tura - 794002, Meghalaya, Yr Estd.: 1987 Status: 2(f)
- Kiang Nonghah Govt. College, JAINTIA HILLS, JOWAI-793150, DIST.: Jaintia Hills, Meghalaya Yr Estd.: 1967 Status: 2(f)&12(B)
- Lady Kean Girls College, SHILLONG-1 DIST.: East Khasi Hills, Meghalaya, Yr Estd.: 1935 Status: 2(f)&12(B)
- Hendipathar College, HENDIPATHAR DIST.: East Garo Hills, Meghalaya, Yr Estd.: 1971 Status: 2(f)&12(B)
- Reid Laban College, Madan Laban Shillong, Meghalaya, Yr Estd.: 1984 Status: 2(f)&12(B)
- Sankardev College, Bishnapur SHILLONG- 793 004, DIST.: East Khasi Hills, Meghalaya Yr Estd.: 1962 Status: 2(f)&12(B)
- Shillong College, SHILLONG-793003 DIST.: East Khasi Hills, Meghalaya, Yr Estd.: 1955 Status: 2(f)&12(B)
- Shillong Commerce College, SHILLONG-2 DIST.: East Khasi Hills, MEGHALAYA-793003 Yr Estd.: 1987 Status: 2(f)&12(B)
- Shillong Law College, SHILLONG DIST.: East Khasi Hills, Meghalaya, Yr Estd.: 1964 Status: 2(f)&12(B)
- St. Anthony's College, SHILLONG-1 DIST.: East Khasi Hills, Meghalaya, Yr Estd.: 1934 Status: 2(f)&12(B)
- St. Edmunds College, SHILLONG-793003 DIST.: East Khasi Hills, Meghalaya, Yr Estd.: 1924 Status: 2(f)&12(B)
- St. Mary's College, SHILLONG-3 DIST.: East Khasi Hills, Meghalaya, Yr Estd.: 1937 Status: 2(f)&12(B)
- Synod College, SHILLONG-2 DIST.: East Khasi Hills, Meghalaya, Yr Estd.: 1965 Status: 2(f)&12(B)
- Tura Govt. College, TURA DIST.: West Garo Hills, MEGHALAYA-794004, Yr Estd.: 1958 Status: 2(f)&12(B)
- Union Christian College, BARAPANI DIST.: East Khasi Hills, Meghalaya, Yr Estd.: 1952 Status: 2(f)&12(B)
- Women's College, SHILLONG DIST.: East Khasi Hills, MEGHALAYA-793003, Yr Estd.: 1967 Status: 2(f)&12(B)

:: Browse other ::

From UGC Colleges	Website Search by State		
8	Mawsynram Border Area College Mawsynram, East Khasi Hills Distt., Meghalaya Meghalaya		Under Section : 2(f)
9	Mendipathar College Mendipathar, Distt., East Garo Hills, Meghalaya Meghalaya		Under Section : 2(f)&12(B)
10	Morning Star College Nongthymmal, Shillong, Meghalaya 793 014 Meghalaya 793 014	North Eastern Hill University	Under Section : 2(f) File No.: 8-/798/2011(CPP-I/C)
11	Raid Laban College Madan Laban Shillong, Meghalaya Meghalaya		Under Section : 2(f)&12(B)
12	Sankardev College Bishnapur Shillong, Distt., East Khasi Hills, Meghalaya 793 004 Meghalaya 793 004		Under Section : 2(f)&12(B)
13	Seng Khasi College Lypung Weiking Jaiaw Shillong, Meghalaya 793 002 Meghalaya 793 002	North Eastern Hill University	Under Section : 2(f)
14	Shillong College Shillong, Distt., East Khasi Hills, Meghalaya 793 003 Meghalaya 793 003		Under Section : 2(f)&12(B)
15	Shillong Commerce College Shillong - 3, Distt., East Khasi Hills, Meghalaya 793 003 Meghalaya 793 003		Under Section : 2(f)&12(B)

ANNEXURE III

Affiliation/ Approval letter from University on B. Sc. (IT) and BPE Courses



NORTH-EASTERN HILL UNIVERSITY

COLLEGE DEVELOPMENT COUNCIL

SHILLONG

Director, College Development Council,
NEHU, Mawkynroh-Umshing, Shillong-22
East Khasi Hills, Meghalaya

(Off) Tel. No. 0364-2721201/1202/1203/1204.
(Mob.) 09436117282.

email: dircdc@nehu.ac.in/cdcnehu@gmail.com

No.CDC/A.6/2014/Vol.-III 3649

Dated the 24th June, 2015

To

The Principal,
Shillong College,
Shillong

Sub: Grant of Provisional Affiliation for (i) B.Sc. (Hons.) in Information Technology and (ii) Bachelor of Physical Education (BPE)

Sir,

I am to convey the decision of the 93rd Academic Council vide Resolution No:AC:93:2015:5:7:(i): held on 8th May,2015 and extended to 12th May,2015 which resolved grant of Provisional Affiliation for (i) B.Sc.(Hons) in Information Technology (IT) and Bachelor of Physical Education (BPE) for a period of 1(one) year w.e.f. the introduction of the courses, subject to approval of the Syllabi and subject combinations by the Academic Council.

The College is required to fulfill the following conditions as laid down by the Inspection Team:

B.Sc.(Hons.) in Information Technology

1. The College should appoint 1(one) more regular teacher. 3(three) faculty members appointed need to clear NET, if required.
2. Proper sitting facilities for faculty members of the new department need to be created.

Bachelor of Physical Education (BPE)

1. The College should appoint 2 (two) more regular teachers for BPE. 2(two)) faculty members appointed need to clear NET, if required.
2. Sports laboratory equipments need to be procured.
3. Proper sitting facilities for faculty members of the new department need to be created.

The fulfillment of the above conditions may be intimated to the undersigned at the earliest for further necessary action.

You are required to apply for renewal of provisional affiliation six months before the expiry of the affiliation period.

Yours faithfully,

(Signature) 24/6/15
(Dr. C. R. Djengdoh)

Director,

College Development Council

Copy to:

1. The Controller of Examinations, NEHU, Shillong.
2. The Assistant Registrar, (Confidential), Examinations, NEHU, Shillong.
3. The Assistant Registrar, (Certificate Cell), Examinations, NEHU, Shillong.
4. The Section Officer, (Store In-Charge, Examinations, NEHU, Shillong
5. The Section Officer, (Confidential), Examinations, NEHU, Shillong.

Director/CDC.

*VP/UPPE/IGAC/NOV/emp/BPE
to be reported to next G.B.
and to start fulfilling the criteria
25/6/15*



राष्ट्रीय मूल्यांकन एवं प्रत्यायन परिषद्
विश्वविद्यालय अनुदान आयोग का स्वायत्त संस्थान
NATIONAL ASSESSMENT AND ACCREDITATION COUNCIL
An Autonomous Institution of the University Grants Commission

Certificate of Accreditation

*The Executive Committee of the
National Assessment and Accreditation Council
on the recommendation of the duly appointed
Peer Team is pleased to declare the*

Shillong College

Shillong, affiliated to North Eastern Hill University, Meghalaya as

*Accredited
at the B level.*

Date : September 16, 2003



*Harad
Director*

1. This certification is valid for a period of Five years with effect from September 16, 2003.
2. An institutional score (%) in the range of 55-60 denotes C grade, 60-65 - C* grade, 65-70 - C** grade, 70-75 - B grade, 75-80 - B* grade, 80-85 - B** grade, 85-90 - A grade, 90-95 - A* grade, 95-100 - A** grade (upper limits exclusive).



राष्ट्रीय मूल्यांकन एवं प्रत्यायन परिषद
विश्वविद्यालय अनुदान आयोग का स्वयत्त संस्थान

NATIONAL ASSESSMENT AND ACCREDITATION COUNCIL
An Autonomous Institution of the University Grants Commission

Certificate of Accreditation

*The Executive Committee of the
National Assessment and Accreditation Council
on the recommendation of the duly appointed
Peer Team is pleased to declare the*

Shillong College

Laitumkharah, Shillong, affiliated to North Eastern Hill University, Meghalaya as

Accredited

with CGPA of 2.92 on four point scale

at B grade

valid up to September 03, 2015

Date : September 04, 2010



HARJAN
Director



"MASTER PLAN OF MAIN CAMPUS AT SHILLONG"

LAYOUT IN PLOT "A" SHOWING POSITIONS OF EXISTING BUILDING AS SHOWN IN RED OUTLINE AND PROPOSED STRUCTURES IN BLUE OUTLINE

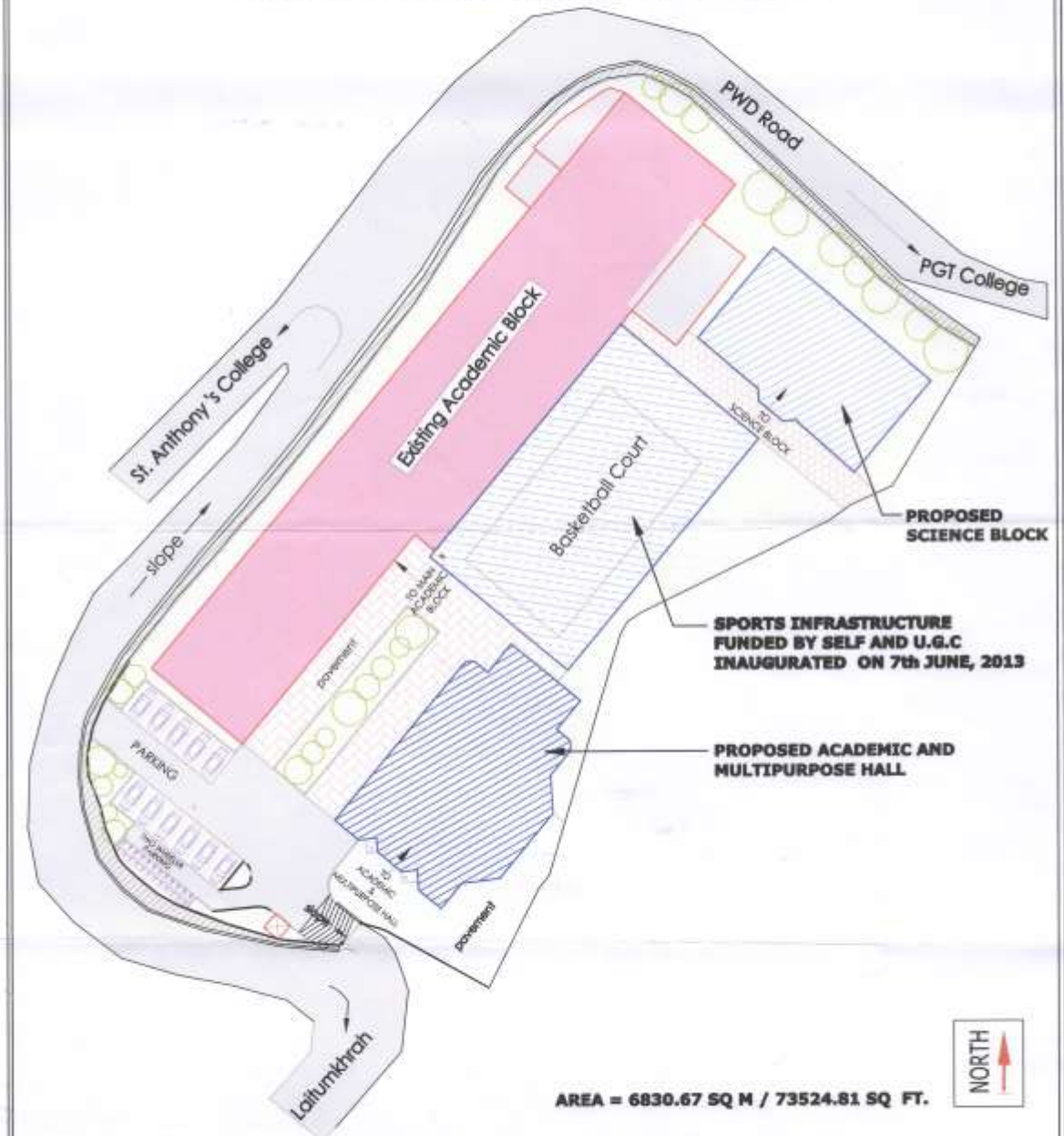

SPORTS INFRASTRUCTURE FUNDED BY SELF AND U.G.C INAUGURATED ON 7th JUNE, 2013

PROPOSED ACADEMIC AND MULTIPURPOSE HALL

AREA = 6830.67 SQ M / 73524.81 SQ FT.

PROPOSED CONSTRUCTION WORKS AT MAIN CAMPUS, SHILLONG

JWATBOR CAJEE & ASSOCIATES ARCHITECTS-ENGINEERS-DESIGNERS "GREEN PATCH VILLA" ARBUTHNOT ROAD, LAITUMKHAH, SHILLONG.

NOTE: DRAWINGS NOT TO BE REPRODUCED OR TO BE MADE. ALL DIMENSIONS ARE IN CM, OR OTHERWISE MENTIONED.
 CHIEF ARCHITECT: A. JWATBOR S. CAJEE
 DEALT BY: A. GEORGE BISHNOI

CONTENTS: SITE PLAN SHOWING BUILDING LAYOUTS OF PLOT "A" SCALE: 1:500

DATE: JUNE 2014
 DRG. NO.: V / 35 / 13 / 01

VI (b)

Master Plan for Second Campus

"MASTER PLAN OF MAIN CAMPUS AT SHILLONG"

LAYOUT IN PLOT "B" SHOWING POSITIONS OF EXISTING BUILDING AS SHOWN IN RED OUTLINE AND PROPOSED STRUCTURES IN BLUE OUTLINE

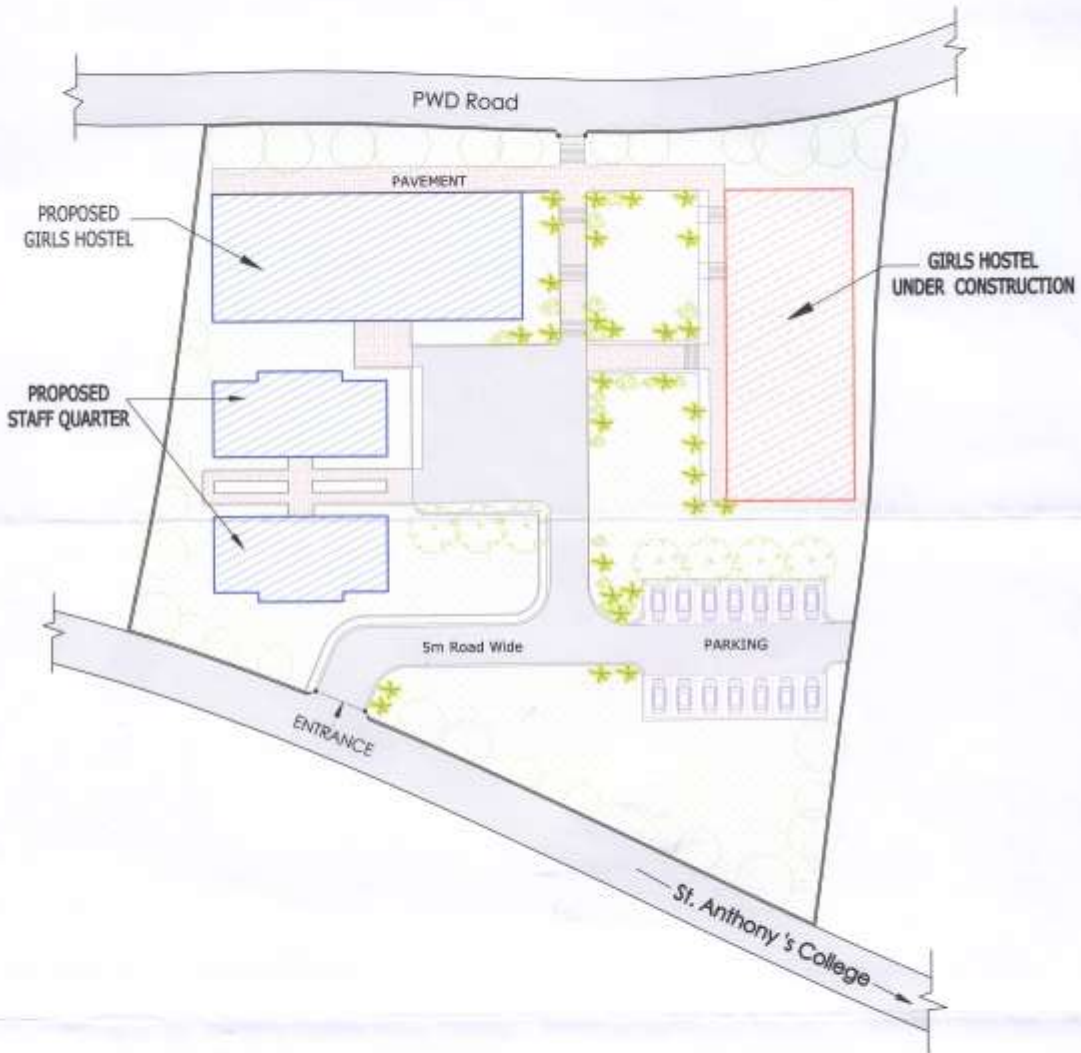

AREA = 3512 SQ.M



CAMPUS DEVELOPMENT PROJECT OF
SHILLONG COLLEGE AT SHILLONG
MAIN CAMPUS
BOYCE ROAD, SHILLONG



JWATBOR CAJEE & ASSOCIATES
ARCHITECTS: ENGINEERS, DESIGNERS
"GREEN PATCH VILLA" ARBUTHNOT
ROAD, LAITUMKHEAN, SHILLONG.

NOTE: DRAWINGS NOT TO BE SCALED ONLY TO BE READ.
ALL DIMENSIONS ARE IN CM, OR OTHERWISE
MENTIONED.

CHIEF ARCHITECT:
Mr. JWATBOR S. CAJEE

DEALT BY:
Mr. GEORGE BISHARD

CONTENTS:
SITE PLAN
SHOWING BUILDING
LAYOUT OF PLOT "B"
SCALE: 1:1000

DATE: JUNE 2013
DRL. NO.:
V. J. 23 / 13 / 02

"MASTER PLAN OF SHILLONG COLLEGE AT EXTENDED CAMPUS SITE, NEW SHILLONG"

PROPOSED FACILITIES:

1. ACADEMIC AND ADMINISTRATIVE BUILDING.
2. BOYS HOSTEL.
3. STAFF QUARTERS.
4. SWIMMING POOL.
5. FOOTBALL PLAYGROUND.
6. OUTDOOR RECREATION ACTIVITIES.
7. BOTANICAL GARDEN.
8. HERBAL GARDEN.



AREA : 29697 SQ.M OR 7.338 ACRES (MORE OR LESS)

PROPOSED CONSTRUCTION WORKS AT EXTENDED CAMPUS, NEW SHILLONG SITE



JWATOR CASE & ASSOCIATES
ARCHITECTS:ENGINEERS-DESIGNERS
"GREEN PATCH VILLA" ARBUTHNOT ROAD, LATTUMKHAH, SHILLONG.

NOTE: DRAWINGS NOT TO BE USED ONLY TO BEING ALL DIMENSIONS ARE IN CM OR OTHERWISE INDICATED.

CHIEF ARCHITECT
A. JWATOR S. CASE

DESK BY:
A. GEORGE WEMBA

CONTENTS -
MASTER PLAN
SCALE : 1:2000



DATE : JUNE 2011
DRL NO. :
V / 11 / 13 / 04

ANNEXURE VII

Library Layout

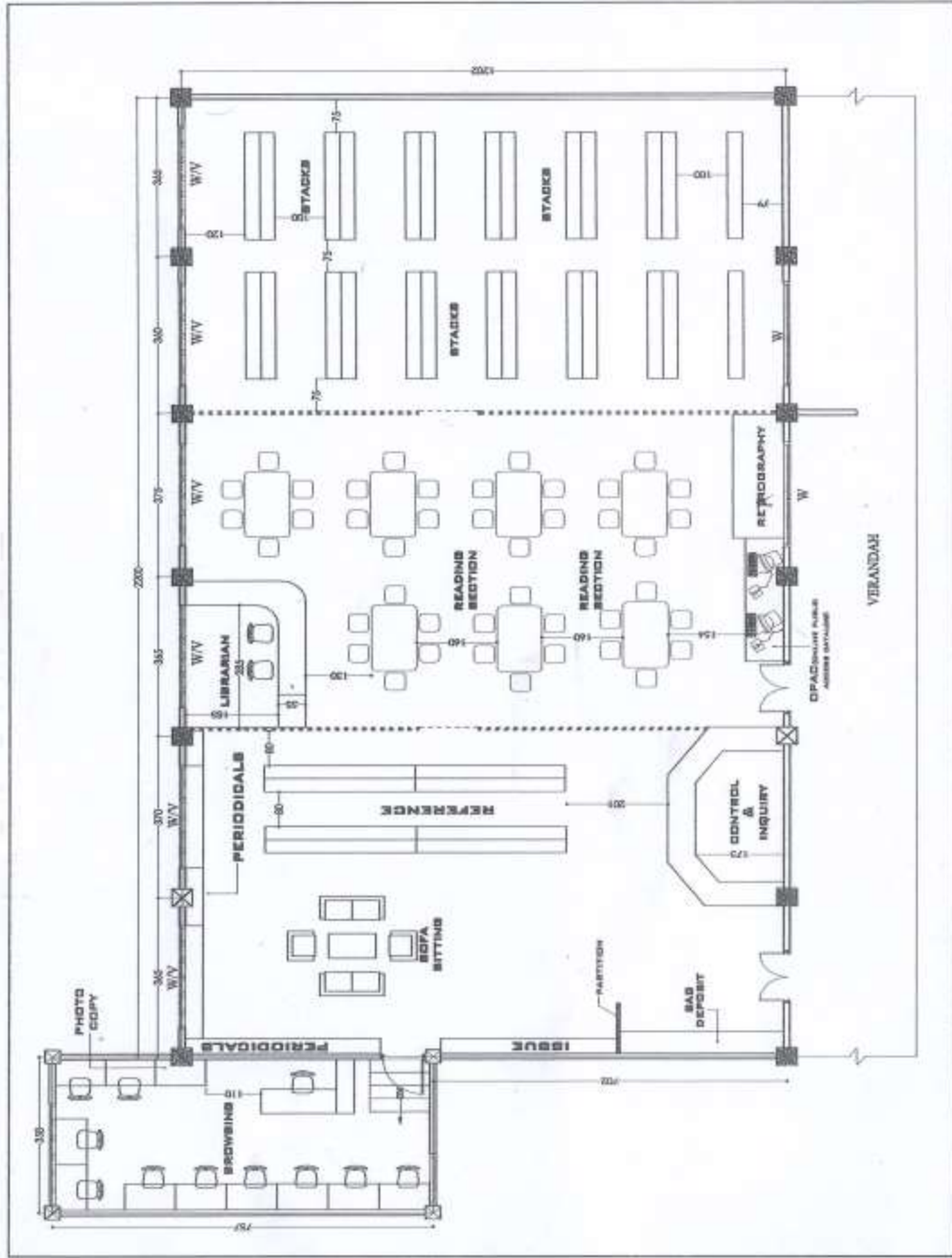

<p>PROPOSED LIBRARY LAYOUT FOR SHILLONG COLLEGE AT SHILLONG</p>		<p>SHILONG COLLEGE & ASSOCIATES ARCHITECTS/ENGINEERS/DRAWERS GREEN PATCH VILLA, ADELPHOT ROAD, NORCHHAWAN, LAITUMORAN, SHILLONG.</p>	<p>CONTENT: LAYOUT PLAN</p>
		<p>SCALE: 1:75 ALL DIMENSIONS ARE IN CM EXCEPT OTHERWISE MENTIONED.</p>	<p>DATE: 22/06/2015 DWG. NO: NCP/RS/02 DEALT BY: A. ROWI KANOUA CHIEF ARCHITECT: A. JINANTOK S. CAJIE</p>

Gmail

Compose

Inbox (1234)

Sent

Import

Spam

Drafts (2)

Trash

More

Your DCF has been uploaded on AISHE portal

Inbox

helpdesk-aishe@nic.in via nic.in
to me

Dear User,

DCF for **Shillong College** has been uploaded successfully on AISHE portal **C-16364-2014**.

We appreciate your sincere efforts in compiling and providing the information. Kindly update your Account details on the AISHE portal under the link [Refr](#)

(This is an auto generated email, kindly do not reply back)

Thanks,
AISHE Team



[Click here to Reply or Forward](#)

0.27 GB (1%) of 15 GB used
[Manage](#)

[Terms](#) - [Privacy](#)

Gmail

COMPOSE

Inbox (1,140)

Sent

Report

Spam Mail

Drafts (2)

Personal

Travel

More

Dictionary.com Word of the Day - *internuncial*: serving to announce or connect. - 5

Your DCF has been uploaded on AISHE portal

Inbox

helpdesk-aishe@nic.in

to me

Dear User,

DCF for **Shillong College** has been uploaded successfully on AISHE portal
C-16364-2013

We appreciate your sincere efforts in compiling and providing the information.

(This is an auto generated email, kindly do not reply back)

Thanks,
AISHE Team



helpdesk-aishe@nic.in